

TECHNICAL SPECIFICATIONS SHEET

FOR THERM	
Spacer Wall Thickness	0.25mm
Thermal Conductivity	TinPlate material = 50 W/mK
	Desiccant = 0.29 W/mK
	Sealant = 0.24 W/mK
Spacer should be below sight line	
All dimensions in millimeters	

ACCURATE GEOMETRY

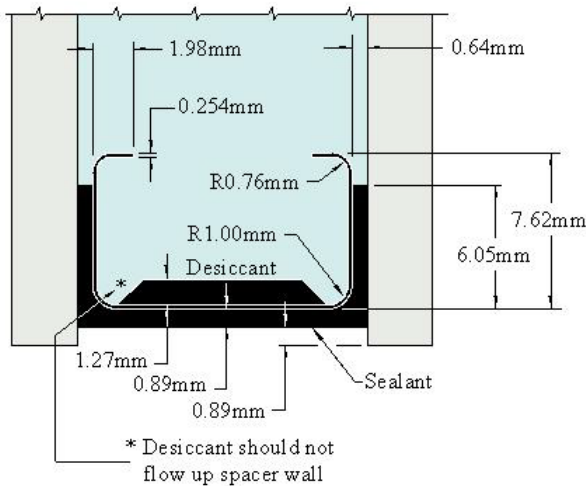

INACCURATE GEOMETRY

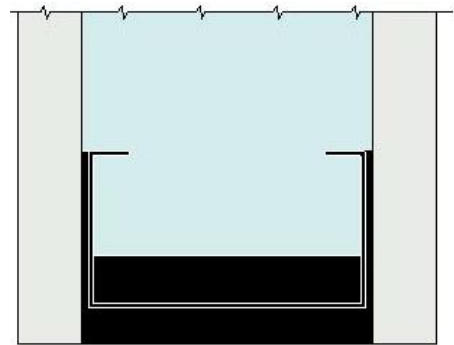

For more information, please contact our Sales Team at 330-963-5401.

For GED certified replacement parts & components, visit [store.gedusa.com](http://store.gedusa.com).

GED Integrated Solutions  
31100 Diamond Pkwy, Glenwillow, OH 44139  
P: 330-963-5401 | [www.gedusa.com](http://www.gedusa.com)

Lit# InterceptMaterialSimModEU-20221114  
Intercept is a registered trademark owned by Vitro.

TECHNICAL SPECIFICATIONS SHEET

FOR THERM	
Spacer Wall Thickness	ThinPlate material = 0.195mm
Thermal Conductivity	ThinPlate material = 50 W/mK
	Desiccant = 0.29 W/mK
	Sealant = 0.24 W/mK
Spacer should be below sight line	
All dimensions in millimeters	

ACCURATE GEOMETRY

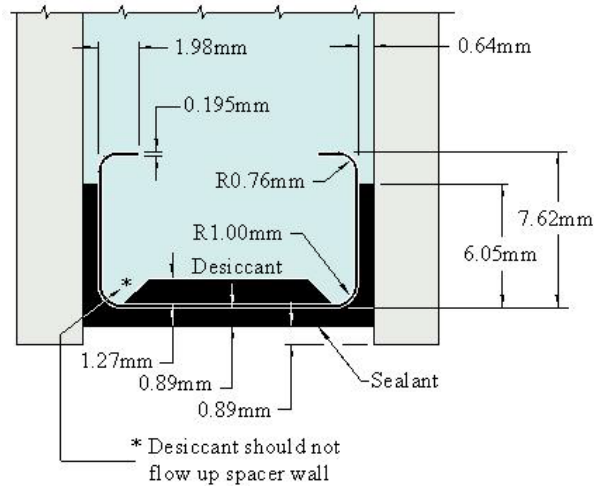

INACCURATE GEOMETRY

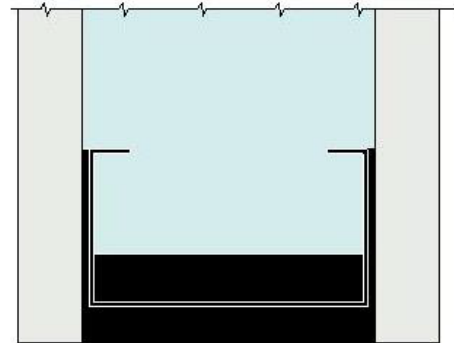

For more information, please contact our Sales Team at 330-963-5401.

For GED certified replacement parts & components, visit [store.gedusa.com](http://store.gedusa.com).

GED Integrated Solutions  
31100 Diamond Pkwy, Glenwillow, OH 44139  
P: 330-963-5401 | [www.gedusa.com](http://www.gedusa.com)

Lit# InterceptMaterialSimModEU-20221114  
Intercept is a registered trademark owned by Vitro.

TECHNICAL SPECIFICATIONS SHEET

FOR THERM	
Spacer Wall Thickness	ThinPlate BlackLine material = 0.195mm
Thermal Conductivity	ThinPlate material = 50 W/mK
	Desiccant = 0.29 W/mK
	Sealant = 0.24 W/mK
Spacer should be below sight line	
All dimensions in millimeters	

ACCURATE GEOMETRY

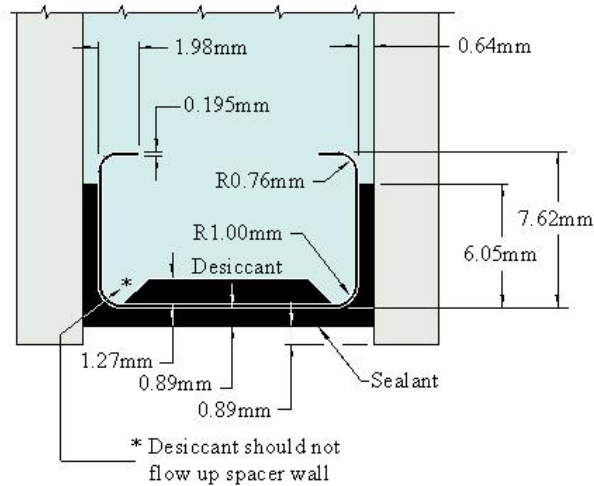

INACCURATE GEOMETRY

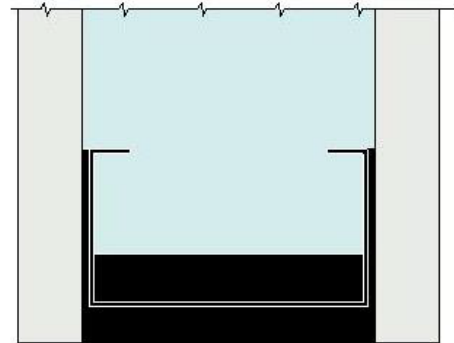

For more information, please contact our Sales Team at 330-963-5401.

For GED certified replacement parts & components, visit [store.gedusa.com](http://store.gedusa.com).

GED Integrated Solutions  
31100 Diamond Pkwy, Glenwillow, OH 44139  
P: 330-963-5401 | [www.gedusa.com](http://www.gedusa.com)

Lit# InterceptMaterialSimModEU-20221114  
Intercept is a registered trademark owned by Vitro.

**TECHNICAL SPECIFICATIONS SHEET**

FOR THERM	
Spacer Wall Thickness	ULTRA material = 0.195mm
Thermal Conductivity	ULTRA material = 13.63 W/mK
	Desiccant = 0.29 W/mK
	Sealant = 0.24 W/mK
Spacer should be below sight line	
All dimensions in millimeters	

**ACCURATE GEOMETRY**

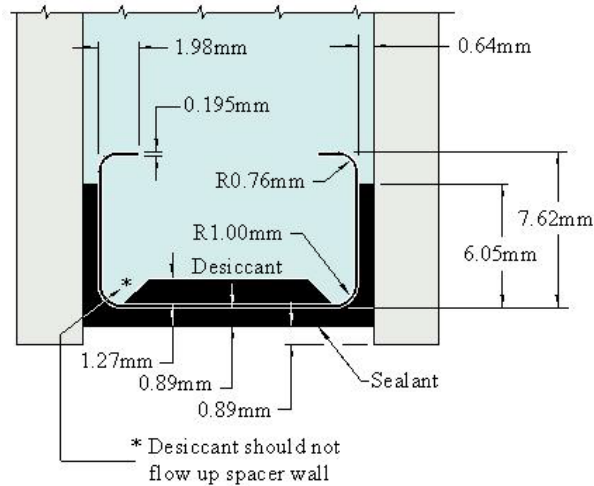

**INACCURATE GEOMETRY**

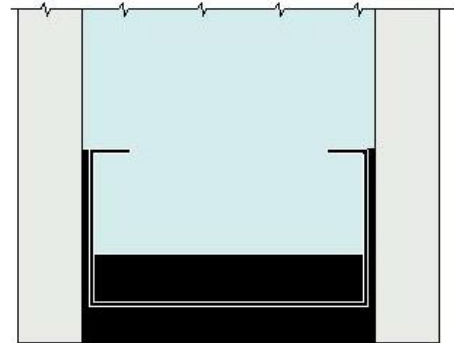

For more information, please contact our Sales Team at 330-963-5401.

For GED certified replacement parts & components, visit [store.gedusa.com](http://store.gedusa.com).

GED Integrated Solutions  
31100 Diamond Pkwy, Glenwillow, OH 44139  
P: 330-963-5401 | [www.gedusa.com](http://www.gedusa.com)

Lit# InterceptMaterialSimModEU-20221114  
Intercept is a registered trademark owned by Vitro.

**TECHNICAL SPECIFICATIONS SHEET**

FOR THERM	
Spacer Wall Thickness	ULTRA Blackline material = 0.195mm
Thermal Conductivity	ULTRA material = 13.63 W/mK
	Desiccant = 0.29 W/mK
	Sealant = 0.24 W/mK
Spacer should be below sight line	
All dimensions in millimeters	

**ACCURATE GEOMETRY**

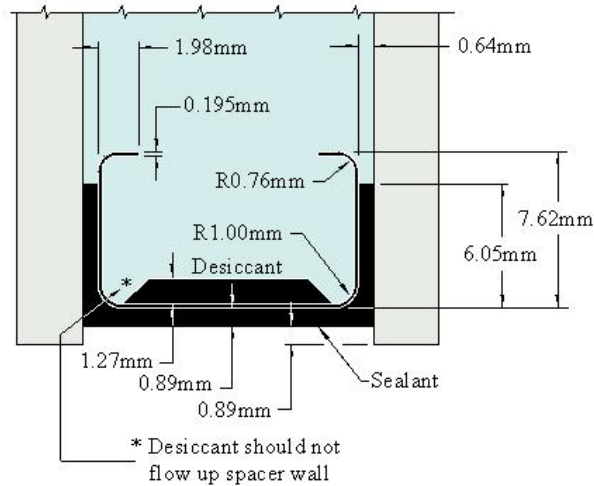

**INACCURATE GEOMETRY**

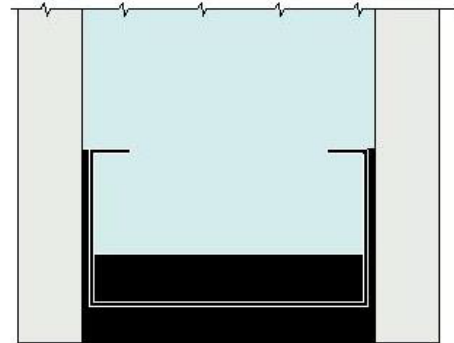

For more information, please contact our Sales Team at 330-963-5401.

For GED certified replacement parts & components, visit [store.gedusa.com](http://store.gedusa.com).

GED Integrated Solutions  
31100 Diamond Pkwy, Glenwillow, OH 44139  
P: 330-963-5401 | [www.gedusa.com](http://www.gedusa.com)

Lit# InterceptMaterialSimModEU-20221114  
Intercept is a registered trademark owned by Vitro.